

STATE OF WYOMING

OFFICE OF THE STATE ENGINEER

BARRETT BUILDING

CHEYENNE, WYOMING 82002

MICRO-
FILMED

FEB 6 '80

10:30

APPLICATION FOR PERMIT TO APPROPRIATE GROUND WATER

FOR OFFICE USE ONLY

Temporary Filing No. U.W. 14-7-213PERMIT NO. U.W. 50947WATER DIVISION NO. 2 DISTRICT 11U.W. DISTRICT Sheridan Co.NOTE: Do not fold this form. Use typewriter
or print neatly with black ink.ALL ITEMS MUST BE COMPLETED
BEFORE APPLICATION IS ACCEPTABLE.NAME AND NUMBER OF WELL Whitfield No. 11. Name of applicant(s) Richard O. Whitfield Phone: 672-77592. Address of applicant(s) Rt. 1, Box 74B, Sheridan, Wyoming Zip: 828013. Name & address of agent to receive correspondence and notices Same As Above

ASSIGNED: SEE CURRENT ENDORSEMENT

4. Use to which the water will be applied: Irrigation ☐ Municipal ☐ Industrial ☐ Stock Watering ☐
Domestic ☒ Miscellaneous ☐ (Describe completely and accurately) _____5. Location of the well: (NOTE: Quarter-quarter (40-acre subdivision) MUST be shown. EXAMPLE: SE $\frac{1}{4}$ NW $\frac{1}{4}$ of Sec. 12, Township 14 North, Range 68 West.)
Sheridan County, SW NE $\frac{1}{4}$ SW NW $\frac{1}{4}$ of Sec. 14 23
T. 54 N., R. 83 W. of the 6th P.M. (or W.R.M.), Wyoming. If located in a platted subdivision, also provide Lot 5, Block NONE of the WINDING BROOK MEADOWS Subdivision (or Add'n) of Subdivision No. 1

6. Mark the well location on the section grid to the right. LOCATION SHOWN IN ITEM 5 MUST AGREE WITH GRID. If the proposed well is for irrigation use, sketch and label all irrigation ditches and canals, stream, reservoirs and other wells. Indicate the point of use or lands to be irrigated from other sources.

7. Estimated depth of the well is 250 feet.8. MAXIMUM quantity of water to be developed and beneficially used: 25 gallons per minute. NOTE: If for domestic or stock use, this application will be processed for a maximum of 25 gallons per minute. SPRINGS: Only springs flowing 25 gallons per minute or less, where the proposed use is domestic or stockwatering, will be considered as ground water appropriations. After approval of this application, some type of artificial diversion must be constructed to qualify for a water right.

9. If use is not irrigation, mark the point(s) or area(s) of use in the tabulation below.

10. If for irrigation use:

a. Describe MAXIMUM acreage to be irrigated in each 40 acre subdivision in the tabulation below.

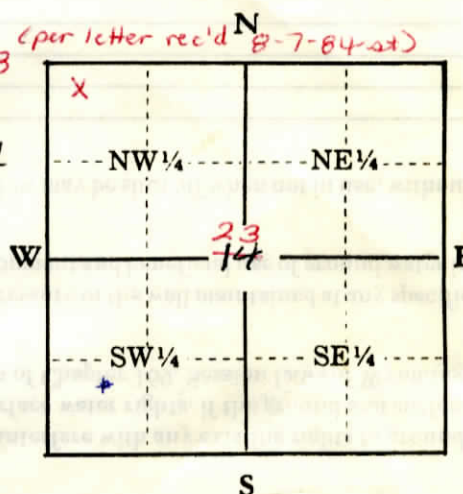
b. ☐ Land will be irrigated from this well only.c. ☐ Land is irrigated from existing water right(s) with water from this well to be additional supply. Describe existing water right(s) under REMARKS.

Scale: 2" = 1 mile

Above diagram represents one full section. Locate well accurately in small square representing 40 ac.

Township	Range	Sec.	NE $\frac{1}{4}$				NW $\frac{1}{4}$				SW $\frac{1}{4}$				SE $\frac{1}{4}$				TOTALS
			NE $\frac{1}{4}$	NW $\frac{1}{4}$	SW $\frac{1}{4}$	SE $\frac{1}{4}$	NE $\frac{1}{4}$	NW $\frac{1}{4}$	SW $\frac{1}{4}$	SE $\frac{1}{4}$	NE $\frac{1}{4}$	NW $\frac{1}{4}$	SW $\frac{1}{4}$	SE $\frac{1}{4}$	NE $\frac{1}{4}$	NW $\frac{1}{4}$	SW $\frac{1}{4}$	SE $\frac{1}{4}$	
54N	83W	23					X						X						

11. If for irrigation use, describe method of irrigation, i.e. center pivot sprinkler, flood, etc. _____

Permit No. U.W. 50947

SEE REVERSE SIDE

Book No. 289 Page No. 80

Applicant

12. The well is to be constructed on lands owned by Richard O. Whitfield
(The granting of a permit does not constitute the granting of right of way. If any easement or right of way is necessary in connection with this application, it should be understood that the responsibility is the applicant's. A copy of the agreement should accompany this application, if the land is privately owned and the owner is not a co-applicant.)
13. The water is to be used on lands owned by Richard O. Whitfield
(If landowner is not the applicant, a copy of the agreement relating to usage of appropriated water on the land should be submitted to this office. If the landowner is included as a co-applicant on the application, this procedure need not be followed.)

REMARKS:

THE LEGALLY REQUIRED FILING FEE MUST ACCOMPANY THIS APPLICATION

Under penalties of perjury, I declare that I have examined this application and to the best of my knowledge and belief it is true, correct and complete.

Richard O. Whitfield
Signature of Applicant or Authorized Agent

12 Jul, 1979
Date

THIS SECTION IS NOT TO BE FILLED IN BY APPLICANT

THE STATE OF WYOMING)

) ss.

STATE ENGINEER'S OFFICE)

This instrument was received and filed for record on the 16 day of Jan., A. D. 1980, at 10:30 o'clock A. M.

Permit No. U.W. 50947

[Signature]
for State Engineer

THIS IS TO CERTIFY that I have examined the foregoing application and do hereby grant the same subject to the following limitations and conditions:

This application is approved subject to the condition that the proposed use shall not interfere with any existing rights to ground water from the same source of supply and is subject to regulation and correlation with surface water rights, if the ground and surface waters are interconnected. The use of water hereunder is subject to the further provisions of Chapter 169, Session Laws of Wyoming, 1957, and any subsequent amendments thereto.

Granting of a permit does not guarantee the right to have the water level or artesian pressure in the well maintained at any specific level. The well should be constructed to a depth adequate to allow for the maximum development and beneficial use of ground water in the source of supply.

If the well is a flowing artesian well, it shall be so constructed and equipped that the flow may be shut off when not in use, without loss of water into surface formations or at the surface.

Approval of this application may be considered as authorization to proceed with construction of the proposed well.

Construction of well will begin within one (1) year from date of approval. A Statement of Completion will be filed within thirty (30) days of completion of construction, including pump installation.

Completion of construction and completion of the beneficial use of water for the purposes specified in Item 4 of this application will be made by December 31, 1981.

The amount of appropriation shall be limited to the quantity to which permittee is entitled as determined at time of proof of application of water to beneficial use.

Witness my hand this 28 day of Jan., A.D. 1980

[Signature]
State Engineer

March 14, 1980 - Notice of Commencement on August 1, 1979 received.

March 14, 1980 - Statement of Completion on September 1, 1979 received.

Beneficial use assumed as of date of completion.

MICRO-FILMED MAY 28 '80

August 7, 1984 - Assignment of all right, title, and interest in and to this permit assigned from Richard O. Whitfield to Howard W. Avery & Jane E.

Dearden per assignment received. See assignment filed in Miscellaneous Notices under Permit No. U.W. 50947.

MICRO-FILMED SEP 5 '84

PERMIT NO U.W. 50947

Priority Date: January 16, 1980 Approval Date: April 25, 1980

December 6, 2004 - All right, title and interest in and to this permit assigned from Howard W. Avery & Jane E. Dearden to **Ralph I. and Karen Hilton, 28 South Rail Road Banner, WY 82832** per Assignment. See Assignment filed in Miscellaneous Notices under Permit No. U.W. 50947.

SCANNED SEP 06 2012

MICRO
FILMED

JUL 05 2005