

Form U.W. 7

IF WELL IS TO BE

ABANDONED, SEE ITEM 20

## STATE OF WYOMING

OFFICE OF THE STATE ENGINEER

## STATEMENT OF COMPLETION AND DESCRIPTION OF WELL

for Domestic or Stock Watering Use Only

A preferred water right is given to such use when the yield or flow does not exceed .056 cubic feet per second or 25 gallons per minute. Domestic use refers to household use and the watering of lawns and gardens for family use, not to exceed one acre.

Permit No. U.W. 13716Temporary Filing No. 6-5-134Water Division No. TWO (7)U.W. District CROOK\*\*Completed Prior  
to May 24, 1969

## WELL LOCATION

CROOK CountyNE  $\frac{1}{4}$  of NW  $\frac{1}{4}$  of Sec. 32T. 53 N., R. 61 W.NAME OF WELL MEADOWS SPRING No. 1

- Owner FRANK OR MARLENE SIMONS
- Address BEULAH, WYOMING 82712
- Agent to receive correspondence Vore Engineering  
Box 213 Upton, Wyoming 82730
- Name & address of driller Hand Dug by Previous Owner  
(Hubert Mathews)

- Well is constructed on lands owned by Frank or Marlene Simons  
(Obtaining of easement or right of way is the responsibility of the applicant's.  
Include copy if land is privately owned and owner is not a co-applicant.)

- Type of construction: Dug ☒ Drilled ☐ \_\_\_\_\_  
Type of Rig \_\_\_\_\_

Driven ☐ Jet ☐ Other \_\_\_\_\_

- Use of Water—Domestic ☐ Stock ☒

- Means of conveyance, distance and direction to point of use

\* 70 ft. North by 1 in. pipe to 625 gallon wooden stock tank

- Date started prior to 9-15-, 1961.
- Date completed prior to 9-30-, 1961. (including pump)
- Date after completion when water was used prior to 9-30-, 1961.

## 12. WELL DESCRIPTION

Total Depth 4 ft. Depth to Water Level 0 ft.

## 13. TEST DATA

Yield 5 gpm How Tested weir  
Drawdown none Length of Test 5 days

## 14. PUMP DATA

Type none Power Source spring development  
(Turbine, Centrifugal, etc.) (Elec., Gas, etc.)Horsepower \_\_\_\_\_ Amount of Water Being Used 5 gpm  
(Gallons per Minute)

## 15. CASING RECORD

## Plain Casing

Size _____	Kind _____	from _____	ft. to _____	ft.
Size _____	Kind _____	from _____	ft. to _____	ft.
Size _____	Kind _____	from _____	ft. to _____	ft.

## Perforated Casing

Size <u>6"</u>	Kind <u>C. I.</u>	from <u>from</u>	ft. to <u>93</u>	ft. to <u>to</u>	ft. to <u>to</u>	ft. to <u>to</u>
Size _____	Kind _____	from _____	ft. to _____	ft. to _____	ft. to _____	ft. to _____

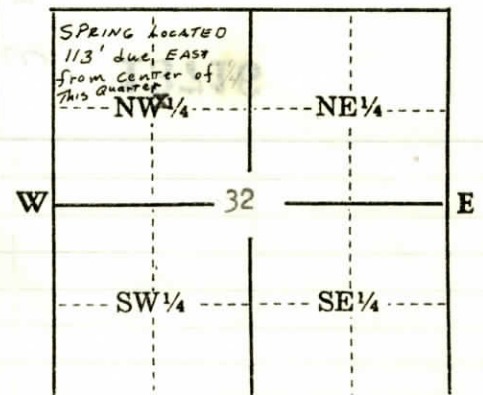

N

W

E

S

Scale: 2" = 1 mile

Above diagram represents one full section. Locate well accurately in small square representing 40 ac.  
or  
fill in the following:

Lot \_\_\_\_\_ &amp; Block \_\_\_\_\_ or Tract \_\_\_\_\_

of the \_\_\_\_\_  
(Subdivision or Addition)of \_\_\_\_\_  
(City, Town or County)

Section \_\_\_\_\_, T. \_\_\_\_\_ N., R. \_\_\_\_\_ W.

\*\*For wells constructed after May 24, 1969, Application Form U.W. 5 must be submitted prior to construction.

Permit No. U.W. 13716Book No. 73 Page No. 160



16. Was surface seal provided? Yes ☐ No ☒ To What Depth \_\_\_\_\_ Material used: \_\_\_\_\_  
Was well gravel packed? Yes ☒ No ☐

17. FLOWING WELL (Owner is responsible for installing control device on flowing well.)  
Does well flow? Yes ☒ No ☐  
Flow controlled by: Valve ☐ Cap ☐ Plug ☐ Does well leak around casing? Yes ☐ No ☐

## UNCONTROLLED

18. **LOG OF WELL**—Clearly indicate first water bearing material and principal water bearing material.

[illegible]

## 19. QUALITY OF WATER INFORMATION

Was a chemical analysis made? Yes ☐ No ☒  
If so, please include a copy of the analysis with this form.

If not, do you consider the water as: Good ☐ Acceptable ☒ Poor ☐ Unusable ☐

Was a bacteriological analysis made? Yes ☐ No ☒

If a domestic well, was the well disinfected by the driller? Yes ☐ No ☒

20. IF WELL IS TO BE ABANDONED, complete only Items 1 through 6, Item 10 and Item 18 (Log of Well) and state reason for abandonment below.

It is the responsibility of the owner to properly plug or fill in the well in order to prevent contamination of ground water and to cover or cap the well at ground level.

REMARKS: \* 93 feet of perforated pipe was installed in the bottom of this draw and gravel packed to collect this spring discharge. This collection dumps into a collection basin which is a 2 ft. diam. concrete structure. From this collection basin the water travels through a 1" pipe to a 625 gallon wooden stock tank.

Under penalties of perjury, I declare that I have examined this form and to the best of my knowledge and belief it is true, correct and complete.

Signature of ~~Owner~~ or Authorized Agent

Date 4-19-, 1972

Date of Receipt:

Date of Priority: September 1961

Date of Approval: April 26, 19

for State Engineer

SCANNED JAN 24 2012