

ck # 2624  
\$25<sup>00</sup>

Note: Do not fold this form. Use typewriter or print neatly with black ink.

RCVD 4-12-2021 10:00AM

# STATE OF WYOMING

OFFICE OF THE STATE ENGINEER

## APPLICATION FOR PERMIT TO APPROPRIATE SURFACE WATER

M. Fegler

**THIS SECTION IS NOT TO BE FILLED IN BY APPLICANT**

Filing/Priority Date

THE STATE OF WYOMING, }  
STATE ENGINEER'S OFFICE } SS.

This instrument was received and filed for record on the 12th day of April,  
2021, at 10 o'clock AM.

Recorded in Book \_\_\_\_\_ of Ditch Permits, on Page \_\_\_\_\_



For State Engineer

Fee Paid \$ 25 Map Filed \_\_\_\_\_

WATER DIVISION NO. 2 DISTRICT NO. 4 COUNTY(IES) Sheridan

TEMPORARY FILING NO. 37 6/212D PERMIT NO. 36526

NAME OF FACILITY: Weatherby Pump

1. Name(s), mailing address and phone no. of applicant(s) is/are Weatherby Family Living Trust DTD  
1550 Yellowtail Drive, Sheridan, WY 82801 307-675-7800

E-mail address: \_\_\_\_\_  
(If more than one applicant, designate one to act as Agent for others)

2. Name & address of agent to receive correspondence and notices: Adam & Brenda Weatherby  
1550 Yellowtail Drive, Sheridan, WY 82801 307-675-7800

E-mail address: \_\_\_\_\_

3. (a) The use to which the water is to be applied is Domestic (lawn & garden)

(b) If more than one beneficial use of water is applied for, the location and ownership of the point of use must be shown in item 10 of the application and the details of the facilities used to divert and convey the appropriation must be shown on the map in sufficient detail to allow the State Engineer to establish the amount of appropriation. In multiple use applications, stock and domestic purposes are limited to 0.056 cubic feet per second.

Griffith Foundation No. 1 Stock Res. (P41325 MF)  
P44000R

4. The source of the proposed appropriation is G. F. Draw, trib. Soldier Creek, trib. Big Goose Creek,  
trib. Tongue River, trib. Yellowstone River, trib. Missouri River

5. The point of diversion of the proposed work is located \_\_\_\_\_ feet distant  
from the \_\_\_\_\_ corner of Section \_\_\_\_\_ T. \_\_\_\_\_ N., R. \_\_\_\_\_ W., and is in the  
NENW of Section 23 T. 56 N., R. 85 W.

Lot \_\_\_\_\_ Block \_\_\_\_\_ Subdivision Name \_\_\_\_\_

Latitude 44.82000 N Longitude 107.06863 W

6. Are any of the lands crossed by the proposed facility owned by the State or Federal government? If so, describe lands and indicate whether State or Federally owned.

No - privately owned lands

7. The carrying capacity of the ditch, canal, pipeline or other facility at the point of diversion is 0.056 cubic feet per second.

8. The accompanying map is prepared in accordance with the State Engineer's Manual of Regulations and Instructions for filing applications and is hereby declared a part of this application. The State Engineer may require the filing of detailed construction plans.

9. The estimated time required for the completion of construction is Existing, and to complete the application of water to the beneficial uses stated in this application is Existing



THE STATE OF WYOMING }  
STATE ENGINEER'S OFFICE } ss.

TEMPORARY FILING NO. 37 6/212D

**THIS IS TO CERTIFY that I have examined the foregoing application and do hereby grant the same subject to the following limitations and conditions:**

**This permit grants only the right to use the water available in the stream after all prior rights are satisfied.**

This permit is conditioned on the holder of this permit securing and/or providing free and unencumbered access to this facility site to allow State Engineer personnel to perform their duties as prescribed by Law. These duties include, but are not limited to, construction inspections and water administration.

This permit is issued to make an existing facility a matter of record. The notice of completion of construction and completion of beneficial use is hereby waived.

This permit is granted subject to the terms of the Yellowstone River Compact, Wyoming Statute § 41-12-601. In the event the state of Wyoming must curtail its post-1950 water uses to comply with the Compact, the applicant shall use water under this permit only for household domestic uses as domestic use is defined by Article II(j) of the Compact, which may include irrigation of land not exceeding a well-defined one-half acre in area.

~~The time for completing the construction work shall terminate on December 31, 20\_\_\_\_\_.~~

~~The time for completing the application of water to beneficial use shall terminate on December 31, 20\_\_\_\_\_, and final proof of appropriation shall be made within 5 years thereafter.~~

Witness my hand this 16 th day of April, A.D. 2021.

 For:  
\_\_\_\_\_  
GREG LANNING, P.E., State Engineer

Permit No. 36526

Page No. \_\_\_\_\_  
(Leave Blank)

PERMIT NO. 36526

PERMIT STATUS

Priority Date April 12, 2021

Approval Date April 16, 2021

NOTICE

This permit, does not constitute a complete water right. It is your authority to begin construction work, which must be commenced within the time allowed in the permit.

Notice of completion of the work described in the permit, must be filed in the State Engineer's Office before the expiration of the time allowed in the permit.

If extensions of time beyond the time limits set forth in the permit are required, requests for same must be in writing, stating why the additional time is required, and must be received in the State Engineer's Office before the expiration of the time allowed in the permit.

Once the Notice of Completion has been filed, Proof of Appropriation will be prepared and sent to your Water Division Superintendent. The Superintendent will arrange with you for an inspection of the facility. Should you desire adjudication, the Proof will be considered by the Board of Control, and, if found to be satisfactory, the Board will issue to you a Certificate of Construction which will constitute a completed water right.

The granting of a permit does not constitute the granting of right-of-way. If any right-of-way is necessary in connection with the application it should be understood that this responsibility is the applicant's.

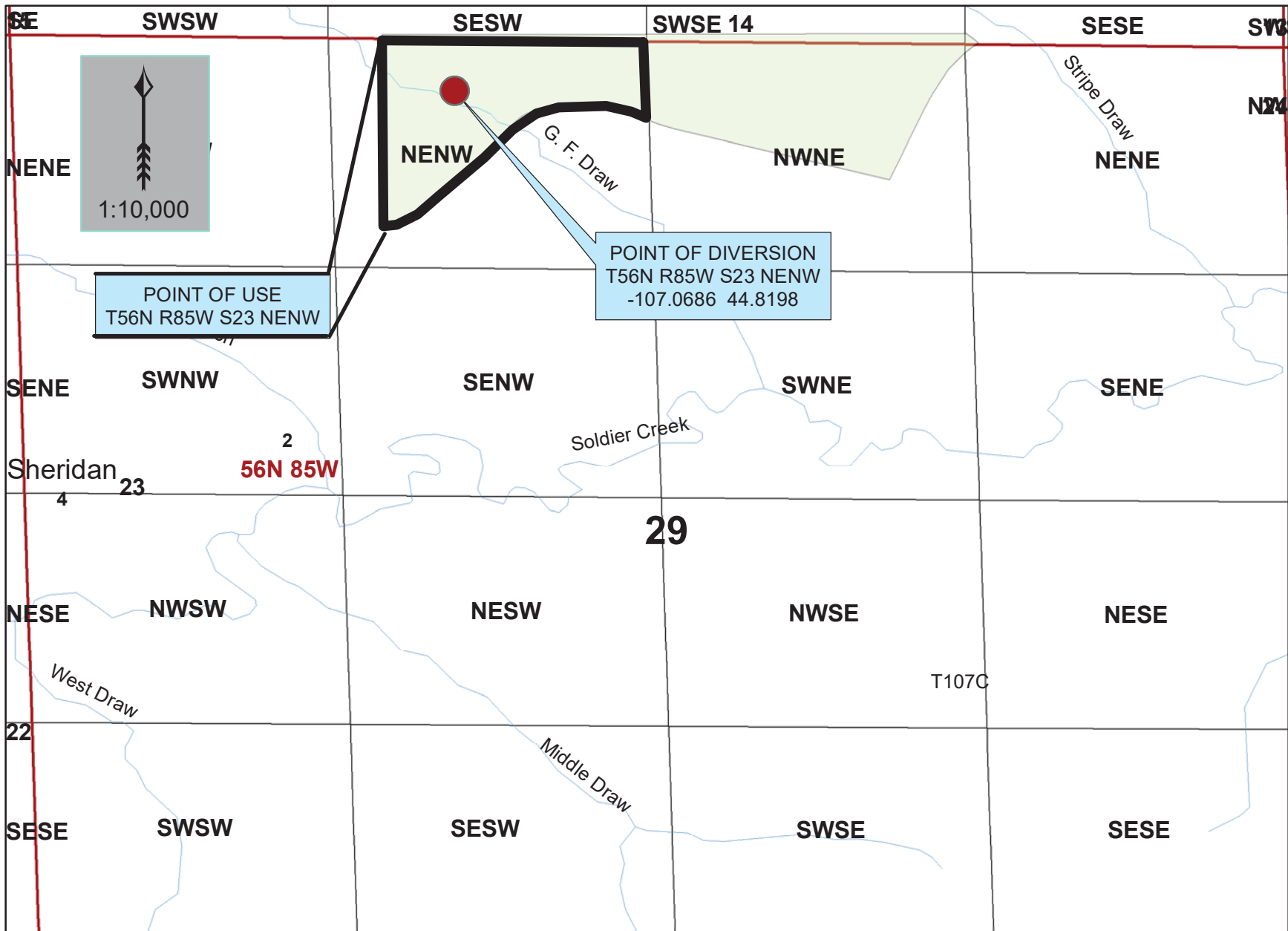

Domestic Use for domestic purposes only at the following point of use not to exceed .056 c.f.s. Watering of lawns/garden shall not exceed 1 acre. Applicant, Adam and Brenda Weatherby, are the landowners of the land described above as the place of use.

MAP TO ACCOMPANY  
THE WEATHERBY PUMP

ADDRESS  
1550 YELLOWTAIL DR  
SHERIDAN, WY 82801

Approved: 4/16/2021	
	For:
Greg Lanning, P.E.	State Engineer

36526.0D